

JCB

1" AIR IMPACT WRENCH INSTRUCTION & USER MANUAL

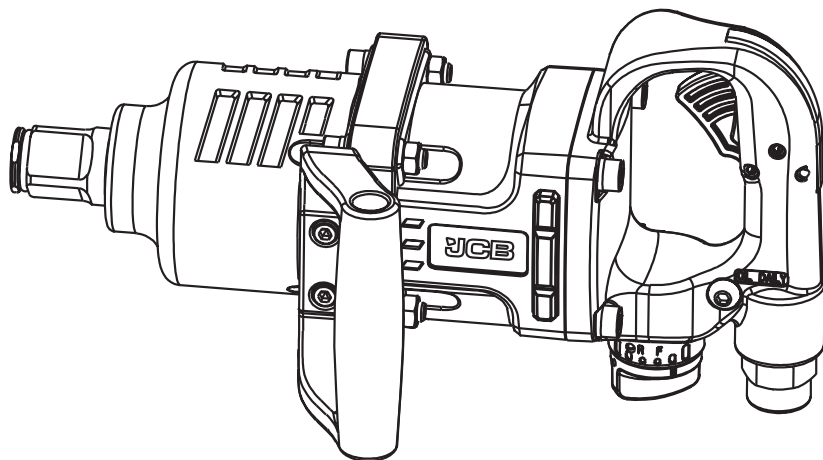

RP7463

Original Instructions

IM-RP7463-EN
Iss: 07/2023

EAC CE



EN

GENERAL WARNINGS & DISPOSAL



To reduce the risk of injury, the user must read the instruction manual.



This symbol is used throughout this manual to warn the user about potential risks. Please read & understand these sections before using the device.



Caution! Wear ear-muffs. The impact of noise can cause damage to hearing.



Caution! Wear protective safety gloves.



Caution! Wear safety goggles. Sparks generated during working or splinters, chips and dust emitted by the device can cause loss of sight. wood and other materials. Never use the device to work on any materials containing asbestos!



Caution! Wear a breathing mask. Dust which is injurious to health can be generated when working on wood and other materials. Never use the device to work on any materials containing asbestos!

The month and year of manufacture can be found within the product serial number e.g. MMYYPXXPAXXXXXX. Where production month (MM) and production year (YY) are included.

Contents

INTRODUCTION	4
SAFETY PRECAUTIONS	4
WORK ENVIRONMENT	4
WARNING	4
TRANSPORT & STORAGE	4
COMPRESSED AIR REQUIREMENTS	5
SAFETY PRECAUTIONS	5
SPECIFICATIONS	6
COMPONENT PARTS	7
OPERATION PROCEDURE	8
PNEUMATIC SYSTEM REQUIREMENTS	8
SERVICE	8
MAINTENANCE	8
WARRANTY STATEMENT	10
DECLARATION OF CONFORMITY	11



INTRODUCTION

For your safety, please read this manual before using any lifting equipment ensuring you fully understand its operation and the safety procedures to be observed. Ensure this manual is retained for future reference and that new users of this product read and understand the content before they use the product.

SAFETY PRECAUTIONS

WARNING!

Failure to comply with these instructions can cause serious injury and damage to the vehicle. If you are in any way unsure, do not attempt to use this product and consult a qualified mechanic.

WORK ENVIRONMENT

1. Keep the work area clean and tidy.
2. Dress appropriately – Do not wear loose clothing or jewelry. Tie long hair out of the way.
3. Keep children and visitors away – Do not let children handle the tool.
4. Do not operate the tool where there are flammable liquids or gases.

Warning

1. Always use the impact wrench as described in these instructions.
2. Always ensure the wrench is not moving and disconnected from the air supply when changing sockets etc. Use only Impact Wrench sockets...DO NOT use standard sockets.

3. Always finish tightening wheel nuts or engine parts with a torque wrench or suitable spanner to the correct torque as recommended by the vehicle manufacturer.
4. Always avoid excessive use of the impact wrench. When tightening a nut or bolt, only allow the wrench to impact briefly to avoid over-tightening.
5. Always ensure that the socket is correctly installed before switching it on.
6. Only use sockets that are specified for impact wrench use.
7. Due to the possible presence of asbestos dust from vehicle brake linings, always wear suitable respiratory protection.
8. Always disconnect from the air supply when changing sockets or when the A wrench is not required for immediate use to avoid accidental starting.
9. Always store this product in a dry, secure place out of reach of children or untrained users.
10. Always use both hands to control the impact wrench.
11. Always ensure the wrench has stopped before putting it down after use.

TRANSPORT & STORAGE

1. Never carry the wrench by the air hose.
2. Never carry the wrench with your finger on the trigger.
3. When not in use the wrench should be disconnected from the air supply and stored in a dry place out of reach of children.
4. Avoid storing the wrench where the temperature is below 0°C

COMPRESSED AIR REQUIREMENTS

1. Use only clean, dry, regulated compressed air as a power source.
2. Air compressors used with the tool must comply with the appropriate European Community Safety Directives.
3. A build-up of moisture or oil in the air compressor will accelerate wear and corrosion in the tool. Ensure any moisture is drained from the compressor daily and the inlet filter is kept clean.
4. If an unusually long air hose is required, (over 8 meters), the line pressure or the hose inside diameter may need to be increased.
5. The air hose must be rated at least 150% of the maximum operating pressure of the tool.
6. A typical airline layout is shown above. If an automatic in-line filter/ the regulator is used, it will keep the tool in good condition, but should be regularly checked and topped up with oil. The lubricator adjusted to approx 2 drops per minute.
7. For optimum performance a minimum 13mm ID air hose is used.
8. Never exceed the maximum operating pressure for the tool. It is recommended that air pressure to this tool does not exceed 90 psi at the tool when running. Higher pressures and dirty air will shorten the life of the tool due to faster wear and is a possible safety hazard.

SAFETY PRECAUTIONS

1. Read all instructions before using this tool. All operators must be fully trained in its use and aware of these safety requirements. All service and repair must be carried out by trained personnel.
2. Never direct air at yourself or anyone else.
3. Install air fitting into inlet bushing of tool.
4. Always remove the air supply to the tool before fitting, adjusting or removing the abrasive/accessory.
5. Always wear required safety equipment when using this tool.
6. When operating always place the tool on the work then start the tool. Always remove the tool from the work before stopping. This will prevent gouging of the work due to excess speed of the abrasive/ accessory.
7. Always adopt a firm footing and/or position and be aware of torque reaction developed by the tool.
8. Use only correct spare parts.
9. Always ensure that the workpiece is firmly fixed to prevent its movement.
10. Check hose and fittings regularly for wear. Do not carry the tool by its hose; always be careful to prevent the tool from being started when carrying the tool with the air supply connected.
11. Dust can be highly combustible. Keep working area clean.
12. Dust from some work processes can cause cancer, birth defects or other respiratory diseases. Risk assessment of these hazards and implementation of appropriate controls is essential.

13. Direct the exhaust so as to minimized disturbance of dust in a dust filled environment
14. Do not operate the tool in explosive atmospheres, such as in the presence of flammable liquids, gases, or dust. The abrasives are able to create sparks when working material, resulting in the ignition of the flammable dust or fumes.
15. Do not exceed maximum recommended air pressure. Use safety equipment as recommended.
16. The tool is not electrically insulated. Do not use where there is a possibility of coming into contact with live electricity, gas pipes, water pipes, etc. Check the area of operation before operation.
17. Take care to avoid entanglement with the moving parts of the tool with clothing, ties, hair, cleaning rags, etc. If entangled, it will cause the body to be pulled towards the work and moving parts of the machine and can be very dangerous.
18. Keep hands away from rotating or accessories, spindles or other moving parts during use.
19. If the tool appears to malfunction, remove from use immediately and arrange for service and repair.
20. Do not allow the tool to free speed without taking precautions to protect any persons or objects from the loss of the abrasive/accessory.
21. Do not allow tool to free run for an extended period of time as this will shorten its life.

SPECIFICATIONS

RP7463	
Squire Drive	1"
Air Consumption	320 l/min
No Load Speed	6000rpm
Max Reverse Torque	2000Nm
Air Inlet	1/2"
Air Hose	16mm (5/8")
Lengh	340mm
Operating Pressure	90PSI (6.3bar)
Weight	7.8kgs

All dimensions are approximate. Images for illustration purposes only.

COMPONENT PARTS

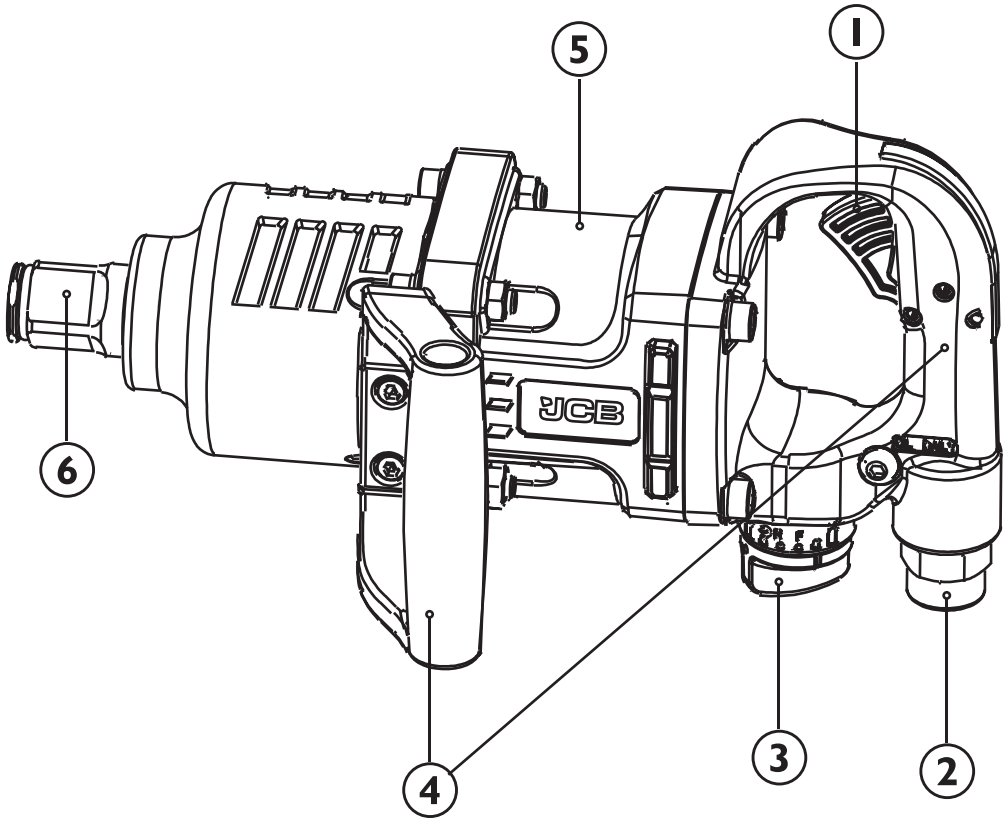

- 1. TRIGGER
- 2. AIR INLET
- 3. TORQUE SWITCH (4 SPEED SELECTION)
- 4. HANDLE
- 5. METAL HOUSING
- 6. SPINDLE

OPERATION PROCEDURE

Read the instructions carefully before operation!

1. The use of tools in any potentially explosive environment is strictly prohibited.
2. It is recommended that the tools be used while standing on a hard and level surface.
3. Always use tools in a well ventilated area.
4. The main causes of potential serious personal injury include falling, tripping, slipping, therefore it is strongly recommended to provide a clean and free surface and a tidy work area before starting to operate the tool.

PNEUMATIC SYSTEM REQUIREMENTS

1. The maximum recommended air pressure during operation should not exceed 90 psi (6.3 atm).
2. Exceeding atmospheric pressure can create unsafe working conditions for the tool.
3. The compressed air should be cooled and a moisture trap filter should be installed at the compressor outlet. Even with a filter, condensate can accumulate in the piping or hose, which can cause premature tool wear. Therefore, it is recommended that an air-lubricator filter be installed between the tool and the compressor.
4. Always use an air compressor of the proper frequency for each tool.
5. Blow out the hose before connecting it to the pneumatic tool. This will prevent moisture and dust from getting inside the tool and causing rust or malfunction.

SERVICE

1. Before connecting the air hose, or after use, blow out the hose with 4-5 drops of pneumatic oil as shown in the supplied illustration.
2. It is recommended that the tool be lubricated every 3, 4 hours if operating continuously.
3. Do not use easily flammable substances for lubrication of the equipment. Use .
4. Do not use any greases other than those recommended by your authorized dealer. Use of unrecommended lubricants may result in poor performance or damage. If you accidentally use a grease that is not recommended, replace the grease with a special one.
5. Follow all recycling laws when you finish using the equipment.

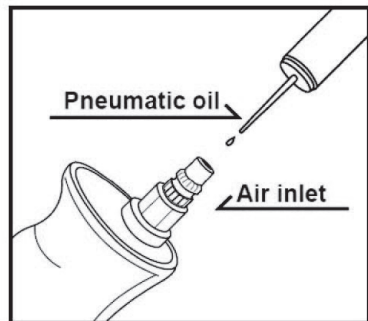

MAINTENANCE

- › Clean the air wrench regularly to remove dirt.
- › After completing work and before storing for a long period of time, pour oil into the tool and let it run without load to allow oil to penetrate all parts.

- Always clean any external contaminants from the tool after completing work.
- Do not use damaged tools or connecting parts.
- Do not use agents that contain chlorine, gasoline or solvents. After cleaning, wipe the tool with a dry cloth.
- - All repair work on the tool must be carried out by a qualified specialist from an authorized service center using original spare parts,
- Regularly check the fasteners on the tool body for tightness, as they may loosen from vibrations. If screws are lost, replace them immediately with new ones. Failure to do so may result in serious danger and injury when using an air tool.
- Store the product in a room with normal humidity at a temperature of at least +5°C.

Recommended option for connecting air tools

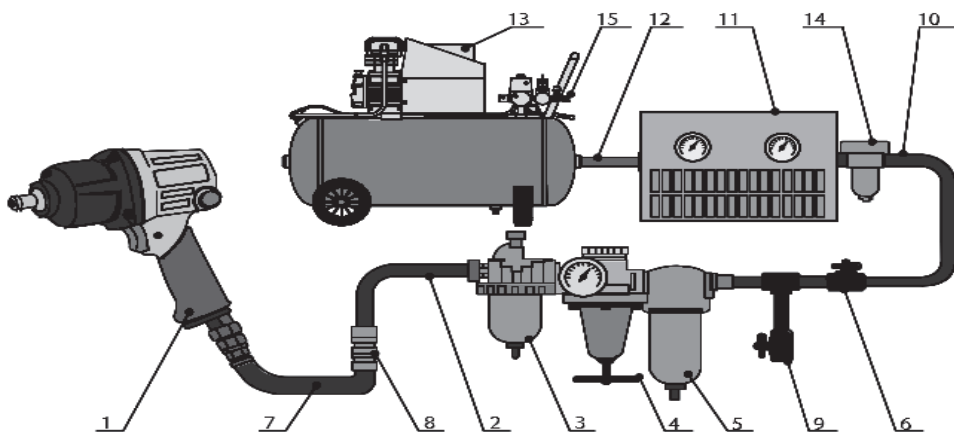

1. Air tool
2. Air hose
3. Lubricator (oil additive)
4. Pressure regulator
5. Filter
6. Stop valve
7. Air hose with fitting
8. Connector

9. Drain valve
10. Air hose
11. Air Dryer
12. Air hose
13. Compressor
14. Automatic drain valve
15. Receiver drain valve

WARRANTY STATEMENT

JCB Power Tools are guaranteed against manufacturing defects for 3 year. Proof of purchase required. This does not affect your statutory rights.

To register your JCB Power Tool, please visit: jcb-tools.com

Warranty cover commences from the date of purchase on the retail sales receipt and is valid only for JCB Tools products bearing the CE and UKCA mark and a visible serial number.

In the unlikely event your JCB Power Tool is subject to a manufacturing fault within the warranty period, JCB Tools may repair the product by replacing defective parts free of charge at our discretion. In the event parts are irreplaceable JCB Tools may replace your product free of charge. The original product will remain the property of JCB Tools in this situation.

The above repair or replacement of products will be undertaken providing that:

- › The product has been subject to fair wear and tear only.
- › The product has not been subject to accidental or cosmetic damage.
- › The product has not been misused and has been used only in accordance with the instruction manual provided.
- › The product has not been subject to overload or insufficient servicing and maintenance.
- › The product has not been subject to any abnormal environmental conditions or inappropriate operating conditions.
- › Repairs have not been attempted by an unauthorised person and no modifications have been made to the product.
- › Repairs have not been undertaken using non-genuine spare parts.



JCB Power Tools used for Hire Fleets or as part of B2B and Service Contracts are not covered by these terms and conditions.

JCB Tools 3 Year Warranty excludes the following (where applicable):

- › Components normally subject to wear such as carbon brushes.
- › Batteries, Chucks and Chargers.
- › Accessories and consumable items.
- › Cases and tool storage products.

If your product develops a fault within 30 days of purchase, return it to the retailer where it was purchased together with your sales receipt. If a product develops a fault after 30 days a warranty claim must be submitted.

JCB TOOLS WILL NOT BE LIABLE FOR ANY INJURIES OR CONSEQUENTIAL DAMAGES RESULTING FROM USE OF THIS PRODUCT.

EU DECLARATION OF CONFORMITY		CE	JCB	UK CA	UK DECLARATION OF CONFORMITY
1.	PRODUCT(S) COVERED BY THIS DECLARATION:	Product: UK Product Code No. EU Product Code No. Factory Reference No.	1" AIR IMPACT WRENCH RP7463 RP7463 RP7463	Batch/PO No. RP220718-HB-2	
2.	IDENTIFICATION DETAILS OF MANUFACTURER:	Name: Address: Country:	Yellow and Black Tools Ltd. (T/A: JCB Tools) Unit 55 Romsey Industrial Estate, Greatbridge Road Romsey, Hampshire SO51 0HR UK		
	AUTHORISED REPRESENTATIVE:	Name: Address: Country:	Trade House Forsage Instrument Pol. Sp. z o. o. 15-561, Grodecka 1A, Bialystok, Polska, Poland		
3. THIS DECLARATION OF CONFORMITY IS ISSUED UNDER THE SOLE RESPONSIBILITY OF THE MANUFACTURER					
4.	OBJECT OF THE DECLARATION:	Product: Function:	1" AIR IMPACT WRENCH General engine repair, home projects, and light industrial applications		
5i.	THE OBJECT OF THE DECLARATION DESCRIBED IN POINT 4 IS IN CONFORMITY WITH THE RELEVANT UNION HARMONISATION LEGISLATION:	2006/42/EC	The Machinery Directive	CE	
5ii.	THE OBJECT OF THE DECLARATION DESCRIBED IN POINT 4 IS IN CONFORMITY WITH THE RELEVANT UK STATUTORY INSTRUMENTS:	2008 No. 1597	The Supply of Machinery (Safety) Regulations 2008	UK CA	
6.	REFERENCES TO THE RELEVANT HARMONISED SAFETY STANDARDS USED OR REFERENCES TO THE OTHER TECHNICAL SPECIFICATIONS IN RELATION TO WHICH CONFORMITY IS DECLARED:	EN ISO 11148-6-2012	Hand-held non-electric power tools - Safety requirements - Part 6: Assembly power tools for threaded fasteners		
7.	ADDITIONAL INFORMATION, THE TECHNICAL DOCUMENTATION FOR THE MACHINERY IS AVAILABLE FROM:	Name: Address: Country:	N/A		
SIGNED FOR AND ON BEHALF OF: PLACE OF ISSUE: DATE OF ISSUE: NAME: FUNCTION: SIGNATURE:		YELLOW AND BLACK TOOLS LTD. ROMSEY, UK. 12/06/2023 JAMES BINGHAM OPERATIONS DIRECTOR 			



EU IMPORTER:

Trade House Forsage Instrument
Pol. Sp. z o.o. 15-561, Gródecka 1A,
Białystok, Polska.

EAC CE



DOWNLOAD YOUR INSTRUCTION MANUAL

AE

BG

DE

ES

FR

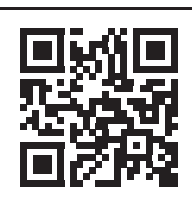
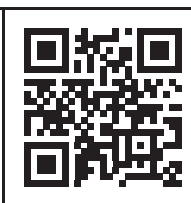
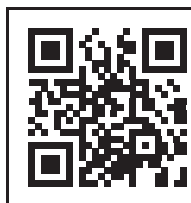

HU

PL

RU

TR

